

# MiniMill 300FF

A standard machine for Fin Fan cooler tube trimming is equipped with custom head and locking system to suit your application (customer to provide drawing of unit). The MiniMill 300FF cutter heads have 3 carbide inserts with 4 Cutting edges each.



☞ Trimming tubes safely and efficiently. Machine locks securely both to the tube and the plug thread of the water box.



	APPLICATION RANGE	STD. LOCKING RANGE	FREE SPEED	POWER	TORQUE	FEED STROKE
<b>MiniMill 300FF</b>	12,5 – 51,0 mm	<b>Depends on attachment</b>	<b>300 Rpm</b>	<b>1,3 Hp</b>	<b>43 Nm</b>	<b>20 mm</b>
	0,492 – 2,000"				<b>31,71 Ft.Lbs</b>	<b>0,787"</b>

Recommended for **FinFan cooler tube facing**

<b>Air consumption:</b>	55 CFM	1,3 m <sup>3</sup> /min	<b>Body width:</b>	2,32"	59 mm	<b>Body height:</b>	13,1"	335 mm	<b>Body weight:</b>	13,2 Lbs	6 kg
-------------------------	--------	-------------------------	--------------------	-------	-------	---------------------	-------	--------	---------------------	----------	------

## FINFAN ATTACHMENT



Special attachment for facing tubes in fin fan gas coolers. A locking shaft with adjustable length and a support bushing are screwed into the plug thread, making this tool the best one available on the market today. The cycle is approx. 1 min from tube to tube. For this application we recommend our 300 Rpm machine

## FINFAN SEAL WELD REMOVAL ATTACHMENT

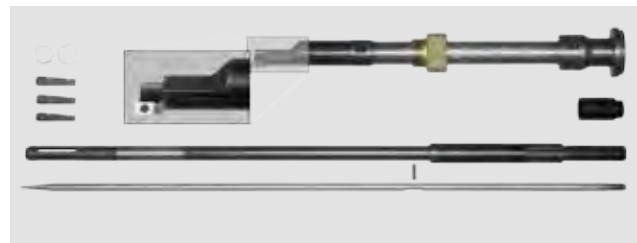

Simply the best solution for seal weld removal from air coolers. Adjustable length locking shaft and support bushing that fits into the plug thread, making this tool the best one available on the market today. A cycle time of approximately 1 min from tube to tube can be expected



## KRAIS Tube Expanders

## Beveling Machines

### LEVER FEED LM



A heavy duty feed handle ideal for heavy wall tube and pipe beveling. Also well suited for strength and seal weld removal applications.

### MULTI FEED MM



Practical and easy to use multi feed system with Star Wheel and build in ratchet mechanism and handle.

### SPEED REDUCER



An optional speed reducer can be used for seal and strength weld removal applications including duplex, super duplex and other hard to machine alloys.

### SPEED ADJUSTMENT VALVE



SAV-500 – perfect solution for all our beveling machines for adjusting cutting speed to suit to the machined tube diameter.

## FINFAN ATTACHMENT PART NUMBERS

FINFAN ATTACHMENT	TUBE CAPACITY			INSERT	NO. INSERTS	SCREW	STANDARD LENGTH		MINIMUM LENGTH		JAWS COVER	
	[INCH]	[MM]	BWG				[INCH]	[MM]	[INCH]	[MM]	MIN	MAX
601-FinFan-1-12"	1,000	25,40	12-23	CI	3	1 1/8	12	304,8	5	127	207MM#36	213MM#36
603-FinFan-1-1/8-12"	1,125	28,58	12-23	CI	3	1 1/4	12	304,8	5	127	211MM#36	217MM#36
605-FinFan-1-1/4-12"	1,250	31,75	11-23	CI	3	1 3/8	12	304,8	5	127	103MM#36	107MM#36
607-FinFan-1-1/2-12"	1,500	38,10	11-23	CI	3	1 5/8	12	304,8	5	127	107MM#36	111MM#36
609-FinFan-1-3/4-12"	1,750	44,45	9-23	CI	3	1 7/8	12	304,8	5	127	111MM#36	115MM#36
611-FinFan-2-12"	2,000	50,80	9-23	CI	3	2 1/8	12	304,8	5	127	115MM#36	119MM#36

## FINFAN ATTACHMENTS AVAILABLE LENGTHS

		601-FINFAN-XX-6	601-FINFAN-XX-8	601-FINFAN-XX-10	601-FINFAN-XX-14	601-FINFAN-XX-16
Length	[inch]	6	8	10	14	16
	[mm]	152,4	203,2	254	355,6	406,4

## EXAMPLE TOOL APPLICATION



☞ Water box demonstration of the simplicity of machine operation.



☞ Operator trimming back tubes prior to seal welding

