

QuickFacer

KRAIS QuickFacer is a rugged, fast, portable tube facing weld end preparation and weld removal tool. It is a micro lathe – designed for various tubes materials, including stainless steel and other high chromium materials. QuickFacer standard machine can be used for machining tube sizes from 8 mm ID to 38 mm OD (0.314" – 1.2") and comes with a 50 mm cutting head.

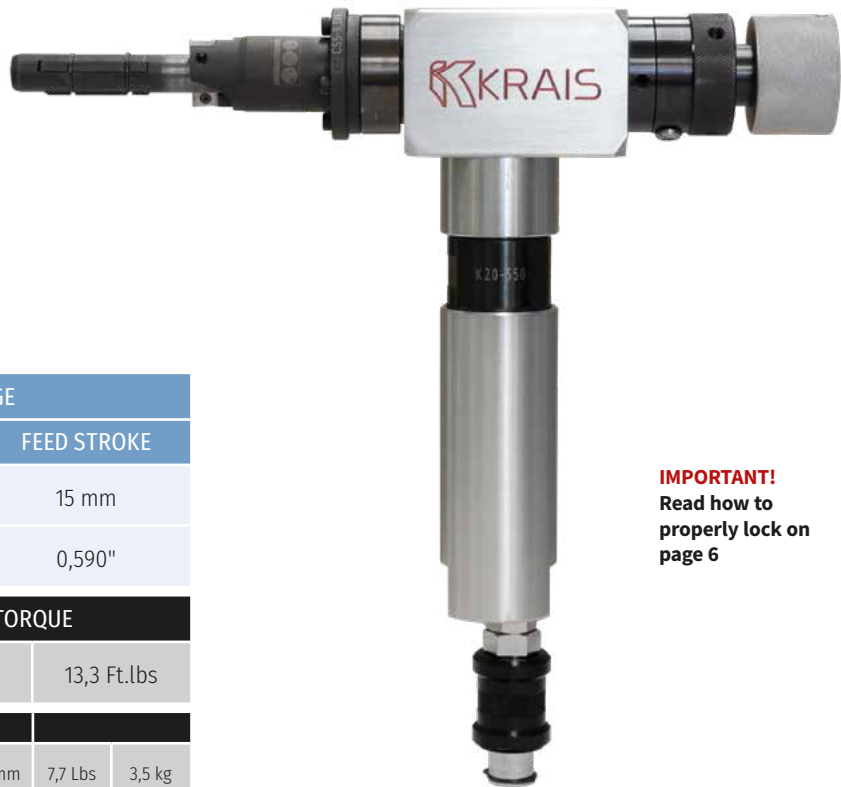

IMPORTANT!
Read how to properly lock on page 6

STANDARD WORKING RANGE					
APPLICATION (ID-OD)		LOCKING RANGE	FEED STROKE		
8 – 38 mm		7,8 – 36 mm	15 mm		
0,314 – 1,496"		0,307 – 1,417"	0,590"		
POWER		FREE SPEED	TORQUE		
0,98 hp		300 rpm	18 Nm	13,3 Ft.lbs	
17 cfm	0,48 m ³ /min	1,73 x 10,82 x 12,20"	44 x 275 x 310 mm	7,7 Lbs	3,5 kg

STANDARD SET UP



MICROSHAFT

A system with interchangeable guide shafts. A complete set covers 10,0 to 15,0 mm ID tubes.

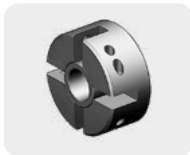

50 MM (2")

The smallest cutter head, designed to fasten the wide range of cutting inserts.

OPT. SHAFT



MINISHAFT

An optional system with interchangeable guide shafts. A complete set covers 12,4 to 48,0 mm ID tubes.

OPTIONAL HEADS



OBMH

Head for outside beveling tubes from 1/2" to 1-1/2" OD

→ TABLE PAGE 108



STWRMH

Head dedicated for strength weld removal. Heads are easy to align and sized per tube diameter, max size 1"

→ TABLE PAGE 107



TFMH

Tube facing milling head for tubes made of any type of material. Utilizes 6% cobalt inserts.

→ TABLE PAGE 107

QuickFacer

LOCKING RANGES FOR SHAFTS

SHAFT	SIZE		JAWS	EXPANSION SHAFT	RANGE [MM]		RANGE [INCH]		SPRING
	[INCH]	[MM]			MIN	MAX	MIN	MAX	
878MM#151	0,307	7,80	378MM#36	MS-158-45	8,00	9,00	0,314	0,354	DW-7,5
885MM#151	0,334	8,50	385MM#36	MS-158-45	9,00	10,00	0,354	0,394	DW-7,7
800MM#151	0,354	9,00	301MM#36	MS-158-51	10,00	11,00	0,394	0,433	DW-7,5
801MM#151	0,394	10,00	303MM#36	MS-158	11,00	12,00	0,433	0,472	DW-8,5
805MM#151	0,453	11,50	305MM#36	MS-158	12,00	13,00	0,472	0,512	DW-10
			307MM#36	MS-158	13,00	14,00	0,512	0,551	
			309MM#36	MS-158	14,00	15,00	0,551	0,591	
901MM#152	0,492	12,40	201MM#36	MM#158-QF	12,40	14,50	0,488	0,571	DW-11
905MM#152	0,547	13,90	203 MM#36	MM#158-QF	13,90	16,00	0,547	0,630	DW-12,5
909MM#152	0,661	16,90	205 MM#36	MM#158-QF	15,90	18,00	0,626	0,709	DW-15,5
			207 MM#36	MM#158-QF	16,90	19,00	0,665	0,748	
			209 MM#36	MM#158-QF	18,90	21,00	0,744	0,827	
			211 MM#36	MM#158-QF	19,90	22,00	0,783	0,866	
			213 MM#36	MM#158-QF	20,90	23,00	0,823	0,906	
214 MM#36	MM#158-QF	21,90	24,00	0,862	0,944				
915MM#152	0,787	20,00	MADE ON ORDER						